

## Description

Soundis Acoustic Batten 50 is a composite 'shallow' acoustic timber batten, used for reducing impact sound on timber and concrete sub floors in both new build and refurbishment projects. The use of the Soundis Acoustic Batten 50 also helps to provide a service zone within the acoustic floating floor build up.

Soundis Acoustic Batten 50 is manufactured using sustainably sourced kiln dried 40mm x 42mm timber battens, which are factory bonded to a high performance 10mm closed cell resilient layer. Manufactured and dispatched from Preston, UK



<b>Batten Dimension</b>	42mm (W) x 1800mm (L) x 50mm (H)
<b>Weight</b>	0.83 kg/Lm - 1.5 kg per batten
<b>Battens Per Pallet</b>	500 battens / 900 Lm
<b>Pallet Dimensions</b>	1200mm (W) x 1800mm (L) x 1100mm (H)
<b>Pallet Weight</b>	770 kg

## Key Benefits

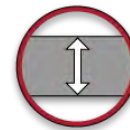

**Low Build Up of 50mm**



**Supplied in 1800mm Lengths to Ensure Stability and Tolerance**



**Robust Detail F-FT-3 for E-FC-1, E-FC-2, E-FC-7 & E-FS-1**

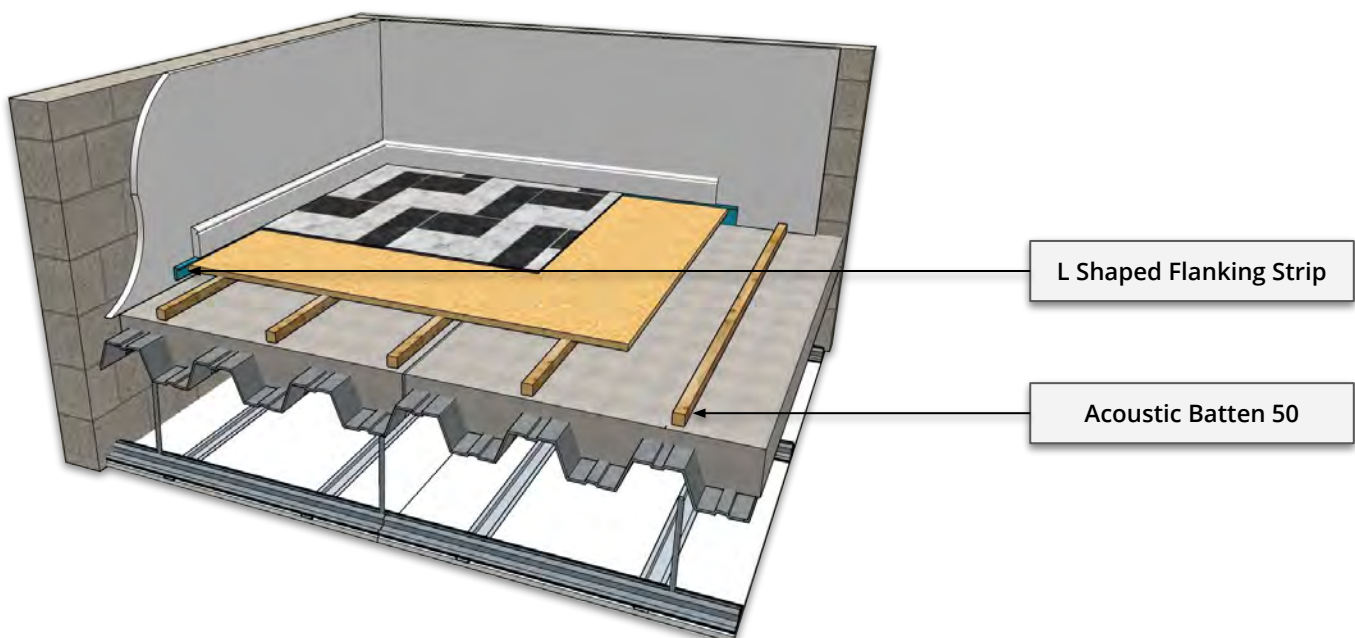

## Typical Acoustic Performances

Manufactured By Soundis

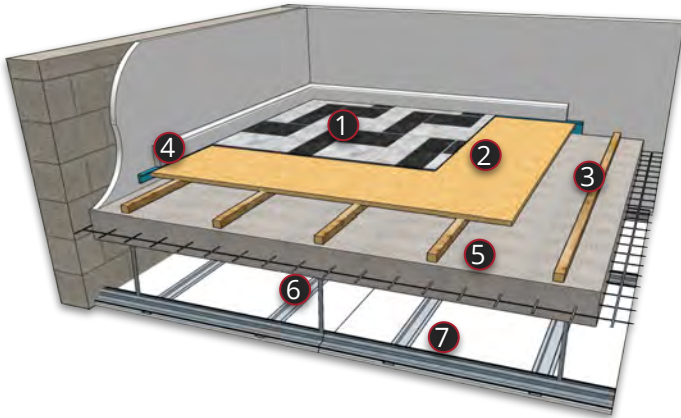

### Concrete Insitu Floor

1. Laminate Tiles
2. 18mm OSB / Chipboard
3. Acoustic Batten 50
4. L Shaped Flanking Strip
5. 200mm Reinforced insitu concrete slab
6. MF Ceiling (min 100mm void)
7. 1 x 9.5mm acoustic plasterboard

<b>DnT,w + Ctr</b>
53dB
<b>LnT,W</b>
46dB
<b>ΔLw</b>
24dB

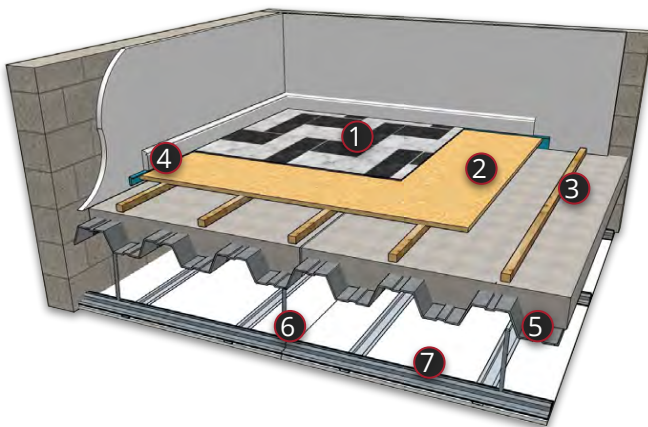

### Profiled Metal Deck

1. Laminate Tiles
2. 18mm OSB / Chipboard
3. Acoustic Batten 50
4. L Shaped Flanking Strip
5. 130mm concrete on profiled metal deck
6. MF ceiling (min 100mm void)
7. 1 x 9.5mm acoustic plasterboard

<b>DnT,w + Ctr</b>
53dB
<b>LnT,W</b>
50dB
<b>ΔLw</b>
24dB

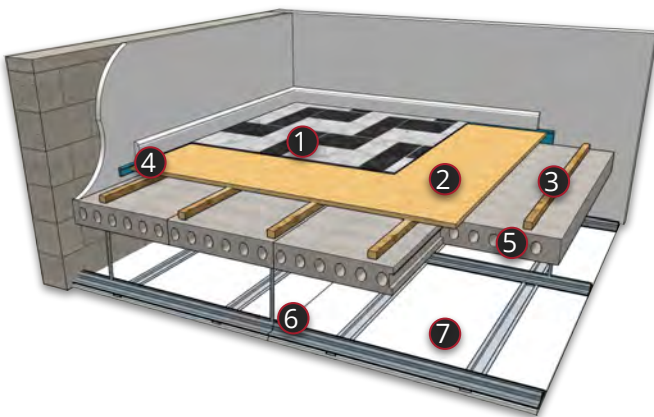

### Pre-Cast Concrete Plank Floor

1. Laminate Tiles
2. 18mm OSB / Chipboard
3. Acoustic Batten 50
4. L Shaped Flanking Strip
5. 150mm Reinforced insitu Concrete Slab
6. MF Ceiling (min 100mm void)
7. 1 x 9.5mm acoustic plasterboard

<b>DnT,w + Ctr</b>
51dB
<b>LnT,W</b>
50dB
<b>ΔLw</b>
24dB

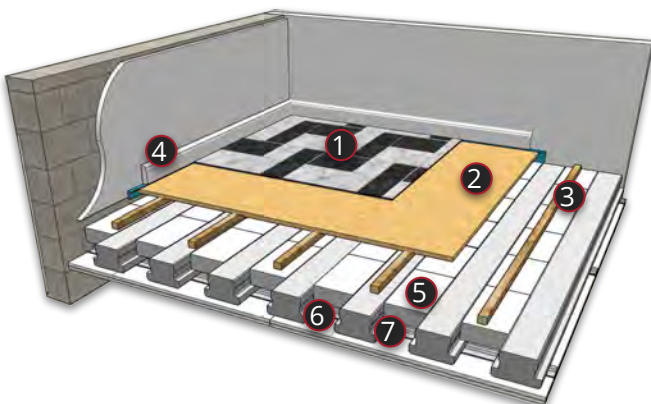

### Beam & Block Floor

1. Laminate Tiles
2. 18mm OSB / Chipboard
3. Acoustic Batten 50
4. L Shaped Flanking Strip
5. Beam & Block min 100mm thick
6. MF ceiling (min 100mm void)
7. 1 x 9.5mm acoustic plasterboard

<b>DnT,w + Ctr</b>
51dB
<b>LnT,W</b>
53dB
<b>ΔLw</b>
24dB

Datasheet No. V2.7/0124