

Description

Soundis Acoustic Batten 70 is a composite 'deep' acoustic timber batten, predominately used within new build timber frame construction for reducing impact sound. Soundis Acoustic Batten 70 will also help to provide a service zone within the acoustic floating floor build up if required and permitted.

Soundis Acoustic Batten 70 is manufactured using sustainably sourced kiln dried 60mm x 45mm timber battens, which are factory bonded to a high performance 10mm closed cell resilient layer.

Manufactured and dispatched from Preston, UK.



Product Weight & Dimensions

Batten Dimension	42mm (W) x 1800mm (L) x 70mm (H)
Weight	1.1 kg/Lm - 2 kg per batten
Battens Per Pallet	350 battens / 630 Lm
Pallet Dimensions	1200mm (W) x 1800mm (L) x 1100mm (H)
Pallet Weight	720 kg

Key Benefits



Deeper Cavity to Improve Airborne Sound Performance



Supplied in 1800mm Lengths to Ensure Stability and Tolerance



Robust detail F-FT-1 for E-FT-1, E-FT-2, E-FT-3, E-FS-1, E-FS-2, E-FC-1, E-FC-2 & E-FC-7

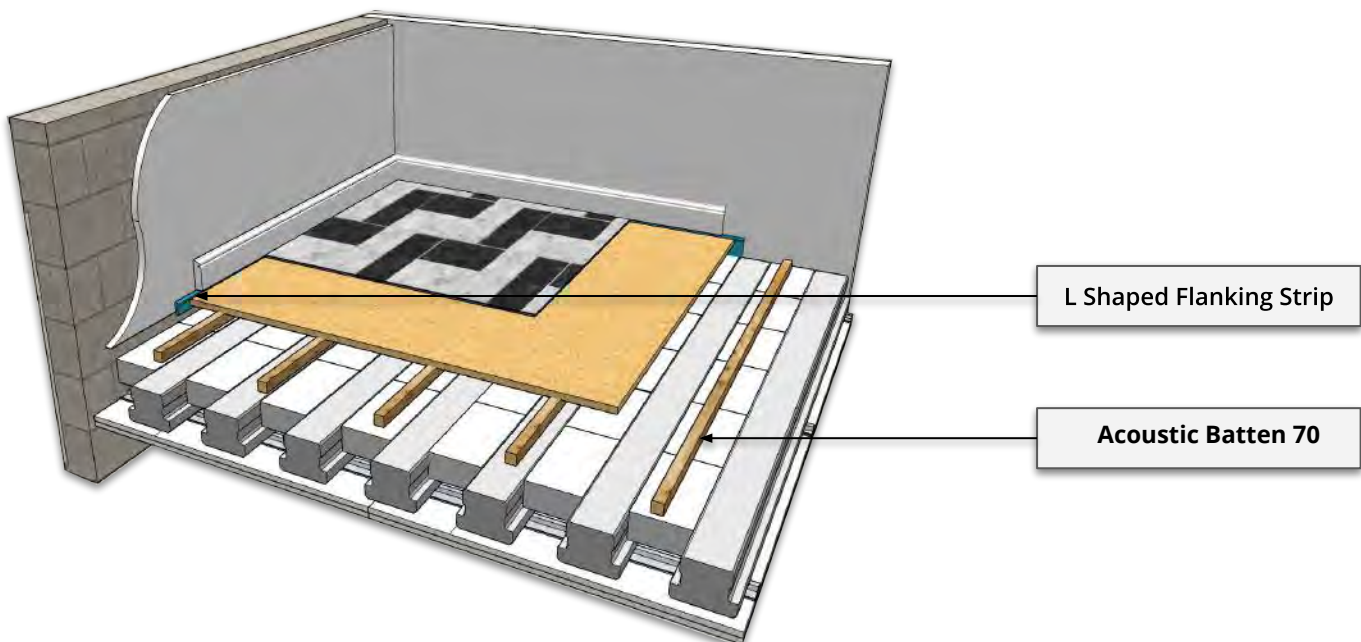

Typical Acoustic Performances

Manufactured By Soundis

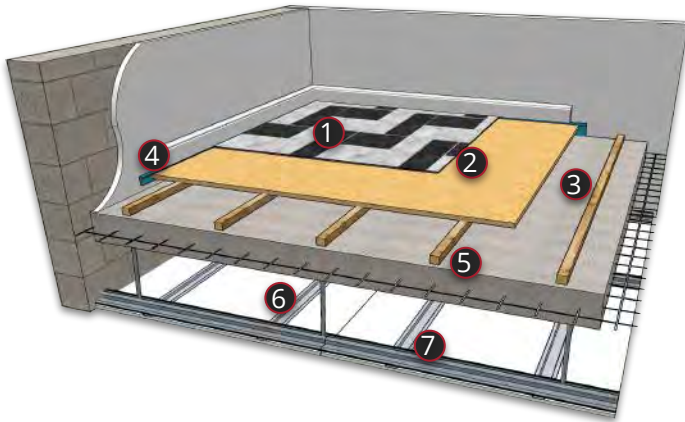

Concrete Insitu Floor

1. Laminate Tiles
2. 18mm OSB / Chipboard
3. Acoustic Batten 70
4. L Shaped Flanking Strip
5. 200mm Reinforced insitu concrete slab
6. MF Ceiling (min 100mm void)
7. 1 x 9.5mm acoustic plasterboard

DnT,w + Ctr	55dB
LnT,W	44dB
ΔL_w	24dB

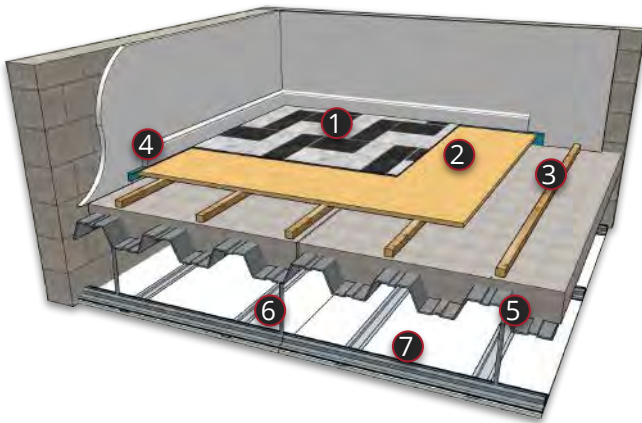

Profiled Metal Deck

1. Laminate Tiles
2. 18mm OSB / Chipboard
3. Acoustic Batten 70
4. L Shaped Flanking Strip
5. 130mm concrete on profiled metal deck
6. MF ceiling (min 100mm void)
7. 1 x 9.5mm acoustic plasterboard

DnT,w + Ctr	55dB
LnT,W	44dB
ΔL_w	24dB

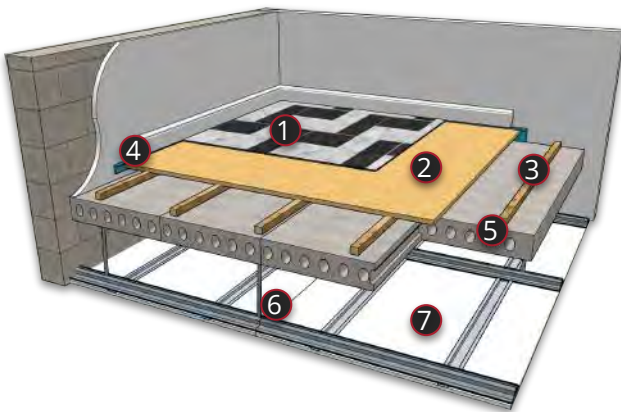

Pre-Cast Concrete Plank Floor

1. Laminate Tiles
2. 18mm OSB / Chipboard
3. Acoustic Batten 70
4. L Shaped Flanking Strip
5. 150mm Reinforced insitu Concrete Slab
6. MF Ceiling (min 100mm void)
7. 1 x 9.5mm acoustic plasterboard

DnT,w + Ctr	53dB
LnT,W	48dB
ΔL_w	24dB

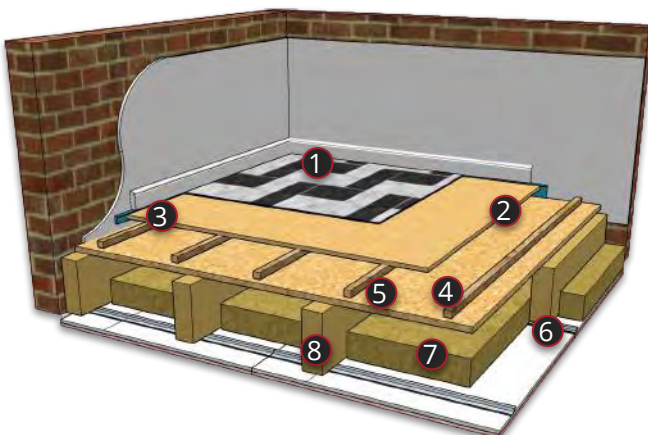

Timber Joisted Floor

1. Screed
2. ScreedFoam 10
3. ScreedEdge Perimeter
4. Acoustic Batten 70
5. 18mm (min) OSB or chipboard subfloor
6. 225mm (min) timber floor joists
7. 16mm resilient bars
8. 2 x 15mm acoustic plasterboard

DnT,w + Ctr	50dB
LnT,W	55dB

Datasheet No. V2.8/0124

Typical Acoustic Performances

Manufactured By Soundis

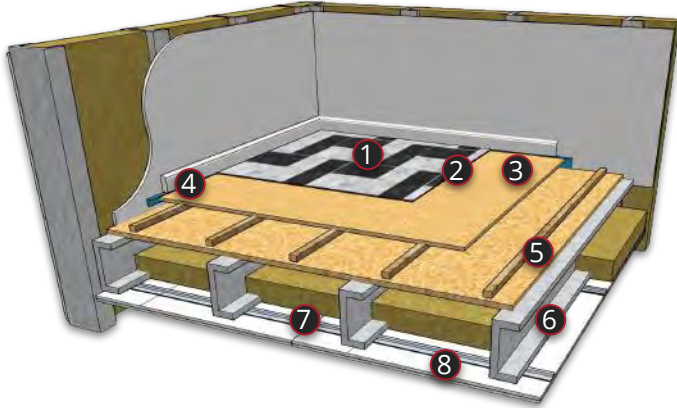

Steel Joisted Floor

1. LVT or sheet vinyl flooring
2. Self-levelling & adhesive layers
3. 18mm OSB / Chipboard
4. L Shaped Flanking Strip
5. Acoustic Batten 70
6. 225mm (min) steel floor joists
7. 16mm resilient bars
8. 2 x 15mm acoustic plasterboard

DnT,w + Ctr
50dB
LnT,W
55dB

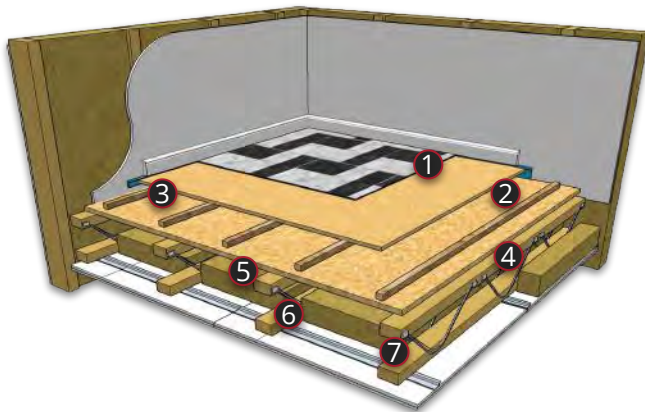

Timber Web Joisted Floor

1. Carpet & underlay
2. 18mm OSB / Chipboard
3. L Shaped Flanking Strip
4. Acoustic Batten 70
5. 225mm (min) timber floor joist
6. 16mm resilient bars
7. 2 x 15mm acoustic plasterboard

DnT,w + Ctr
51dB
LnT,W
53dB

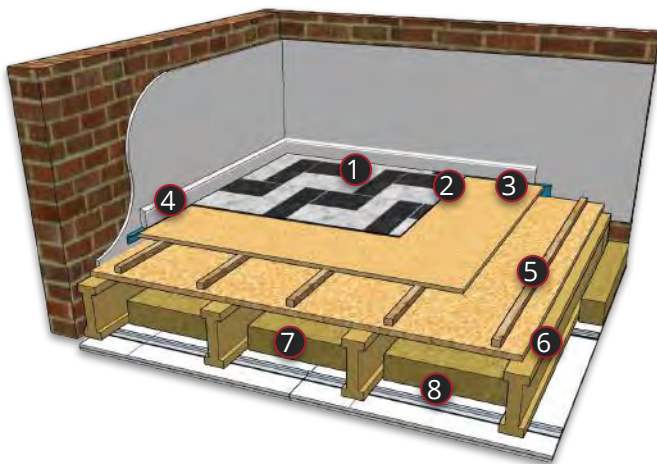

Timber L Beam Joisted Floor

1. LVT or sheet vinyl flooring
2. Self-levelling & adhesive layers
3. 18mm OSB / Chipboard
4. L Shaped Flanking Strip
5. 18mm (min) OSB chipboard subfloor
6. 225mm (min) steel floor joists
7. 16mm resilient bars
8. 2 x 15mm acoustic plasterboard

DnT,w + Ctr
51dB
LnT,W
54dB