



Description

ChipPanel 28F is a composite acoustic overlay panel for use on timber floors in refurbishment projects or concrete subfloors in new build applications.

ChipPanel 28F is a cost effective solution for a multitude of applications. Improved impact sound performance is achieved through introducing a resilient layer to the floor by using a 18mm P5 chipboard, which is factory bonded to a high performance 10mm foam layer. Giving a ΔL_w performance of 18dB.

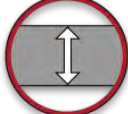

Technical Properties	
Panel Dimension	600mm (W) x 2400mm (L) x 28mm (H)
Panel m²	1.44 m ² Per Panel
Panel Per Pallet	70 Panels (100.8 m ²)
Weight	12.5 kg/m ² - 18 kg Per Panel
Pallet Dimensions	2400mm (W) x 1200mm (L) x 820mm (H)
Pallet Weight	1280 kg

Key Benefits	
	22mm Chip Board Option For Additional Mass & Strength
	Low Build Up of Only 28mm
	Robust Detail Approved E-FC-1, E-FC-2, E-FS-1

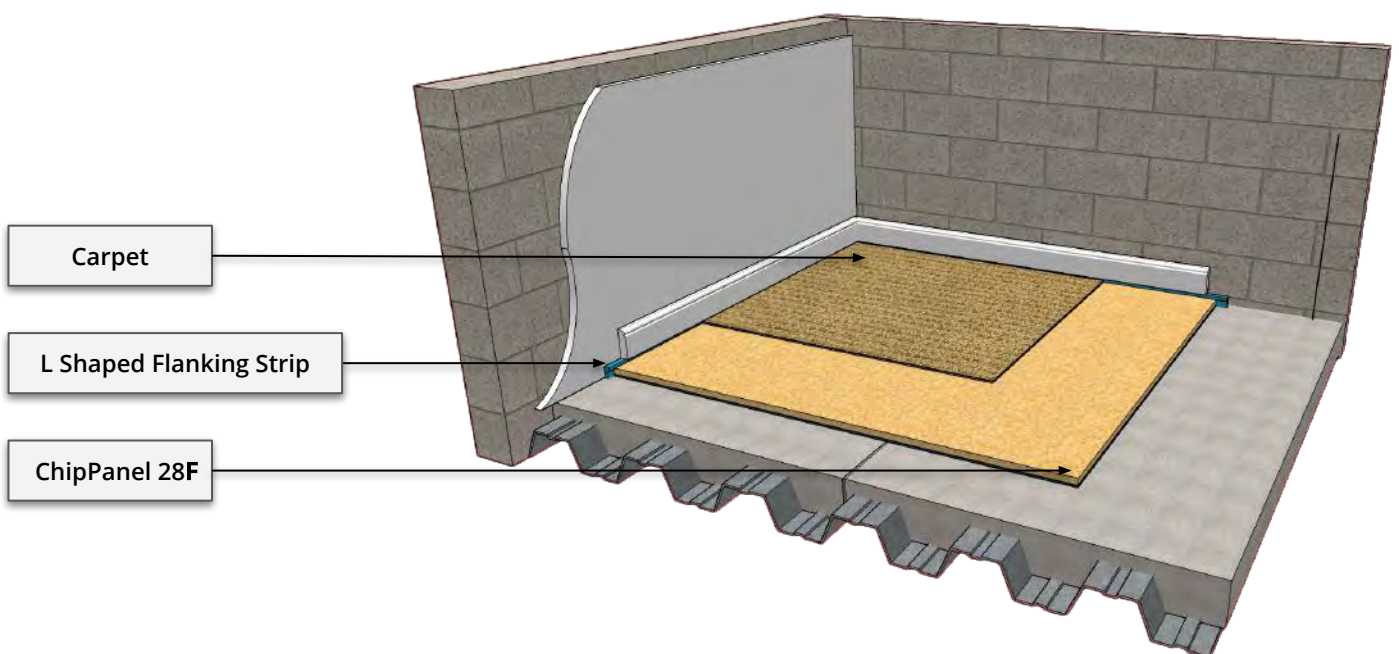

Typical Acoustic Performances

Manufactured By Soundis

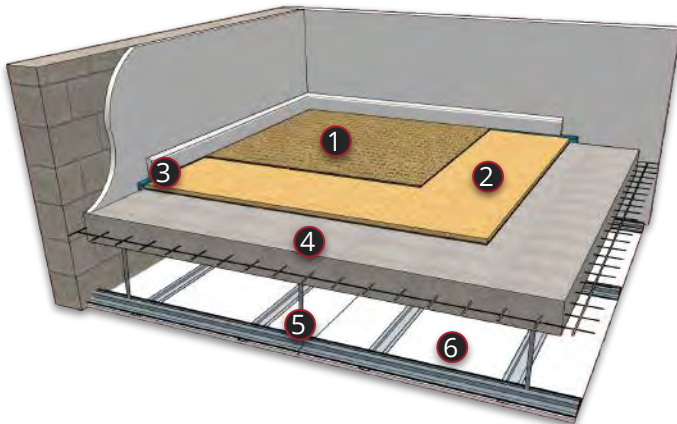

Concrete Insitu Floor

1. Carpet
2. Soundis ChipPanel 28F
3. L Shaped Flanking Strip
4. 200mm Reinforced Insitu Concrete Slab
5. MF Ceiling (Minimum 100mm Void)
6. 1 x 9.5mm Acoustic Plasterboard

DnT,w + Ctr
51dB
LnT,W
50dB
ΔLw
20dB

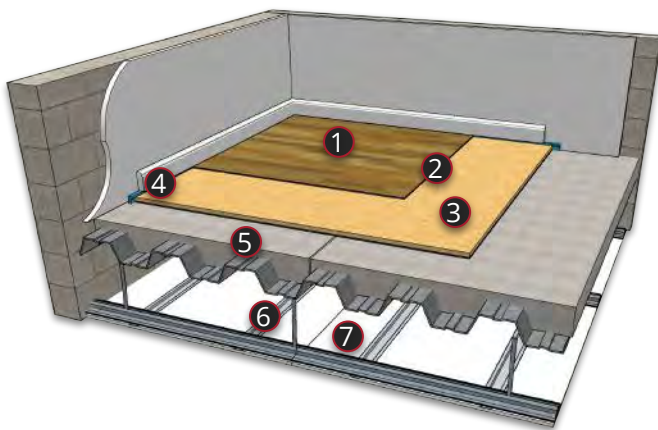

Profiled Metal Deck

1. Laminate flooring
2. Adhesive or decoupling layer
3. Soundis ChipPanel 28F
4. L Shaped Flanking Strip
5. 130mm concrete on profiled metal deck
6. MF ceiling (min 100mm void)
7. 1 x 9.5mm acoustic plasterboard

DnT,w + Ctr
51dB
LnT,W
49dB