

Description

DeflectaMat 8 is a thin, high mass underlay system. At only 9mm thick and weighing 8.3kg per m², Deflecta Mat 8 is the thinnest acoustic underlay in our range, giving good airborne sound performance and exceptional impact sound performance.

DeflectaMat 8 is manufactured from 1 layer of 4mm 7.5kg/m² barrier mat, bonded to a 5mm recycled polyester fleece resilient layer.

DeflectaMat 8 is ideal for use under carpet or instances where carpets are being replaced with new timber flooring. For timber flooring less than 6mm thick (Engineered or laminate) For vinyl floor finishes or a 6mm plywood/mdf should be laid over the DeflectaMat 8. A self leveling screed should also be considered.



Technical Properties

Panel Dimension	1000mm (W) x 1200mm (L) x 9mm (H)
Panel m²	1.2 m ² Per Panel
Panel Per Pallet	100 Panels (120 m ²)
Weight	8.3kg/m ² - 8.3 kg Per Panel
Pallet Dimensions	1000mm (W) x 1200mm (L) x 900mm (H)
Pallet Weight	820 kg

Key Benefits



Easy To Install

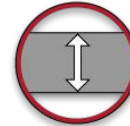

Only 9mm Thick



Reduces Airborne Noise



Excellent Impact Sound Performance

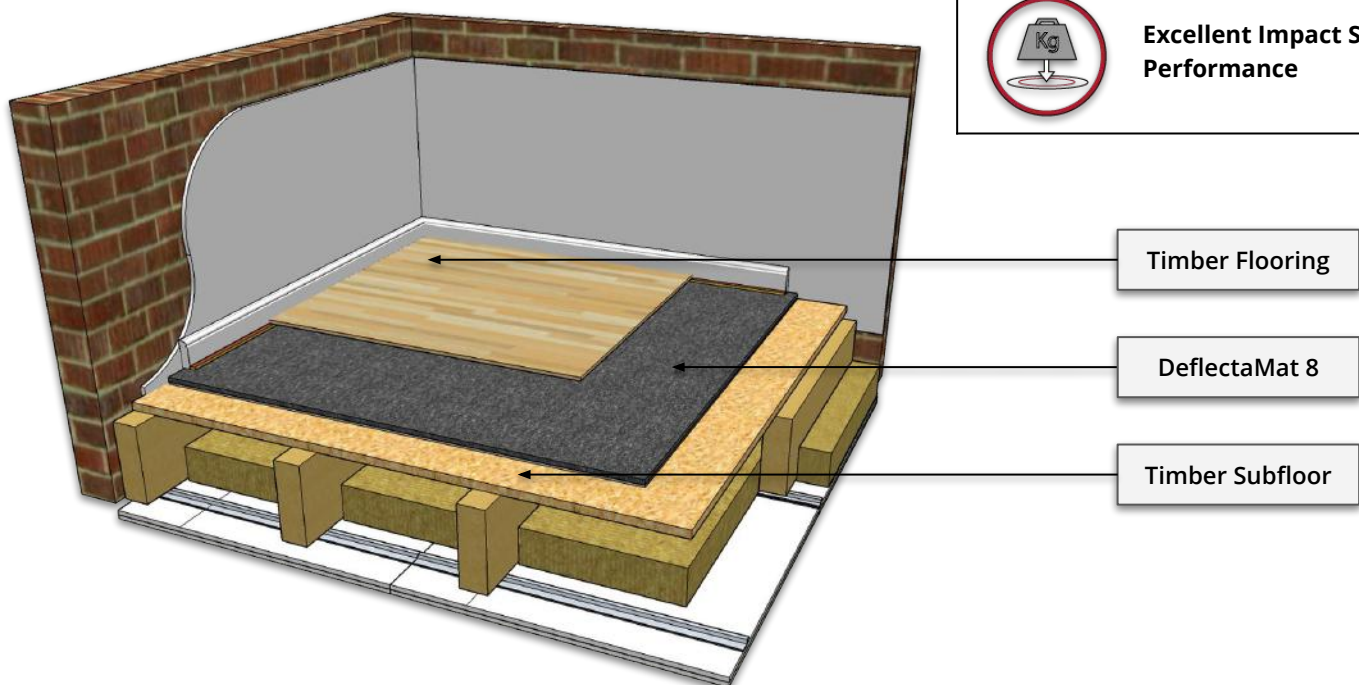

Typical Acoustic Performances

Manufactured By Soundis

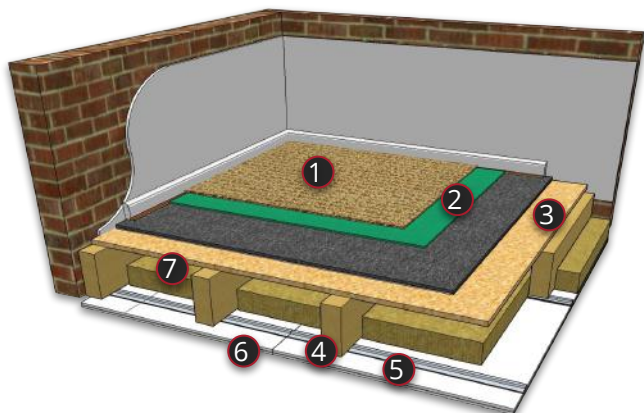

Timber Joisted Floor

1. Carpet
2. DeflectaMat 8
3. 18mm timber Subfloor
4. 225mm (min) timber floor joist
5. 16mm resilient bars
6. 2 x 15mm acoustic plasterboard
7. 100mm 45kg/m³ mineral wool

RW + Ctr
48 dB
Ln,W
39 dB