

Description

Soundis dry ScreedPanel 28 WF is a composite panel for acoustic flooring applications, consisting of an upper surface of 18mm reinforced cement fibre panel factory bonded to a 10mm recycled wood fibre resilient layer. These dry fit screed replacement panels reduce floor height and save on drying times over traditional screeds

Soundis dry ScreedPanel 28 WF is ideal for acoustic flooring applications with higher floor loading requirements and high levels of both airborne and impact and airborne sound performance are required such as educational, healthcare and student accommodation schemes.



Technical Properties

| | |
|--------------------------------------|----------------------------------------|
| Panel Dimensions | 600mm (W) x 1200mm (L) x 18mm (H) |
| Panel m² | 0.72 m ² Per Panel |
| Panel Per Pallet | 62 Panels (44.64 m ²) |
| Weight | 25 kg/m ² - 18 kg Per Panel |
| Panel Dimensions | 1200mm (W) x 1200mm (L) x 1050mm (H) |
| Pallet Weight | 1135 kg |
| Density | 1350 kg/m ³ |
| Thermal Expansion Coefficient | 0,005 mm/mk |
| Thermal Conductivity | 0.20 W/mK |
| Fire Performance | E (as per EN13051-1) |
| Water Impermeability | Impermeable according to EN 12467 |

Key Benefits

| | |
|--|----------------------------------------------------|
| | Can Be Laid Directly Without Decoupling Mat |
| | Non-combustible |
| | High Density |
| | T&G No Screws Required |
| | Impervious To Water |

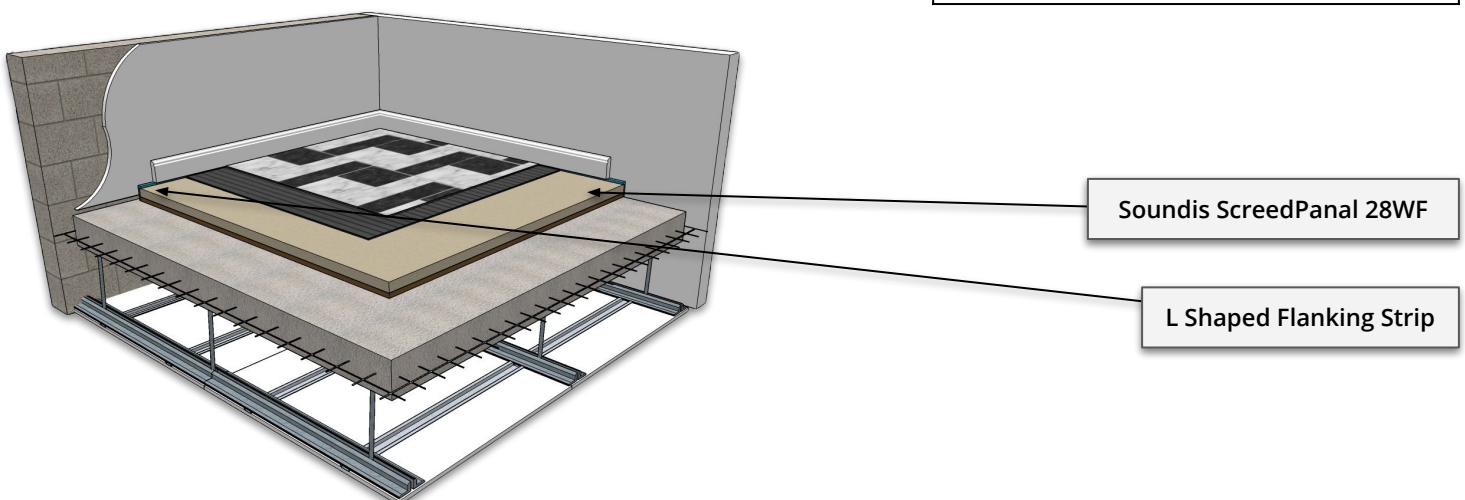

Typical Acoustic Performances

Manufactured By Soundis

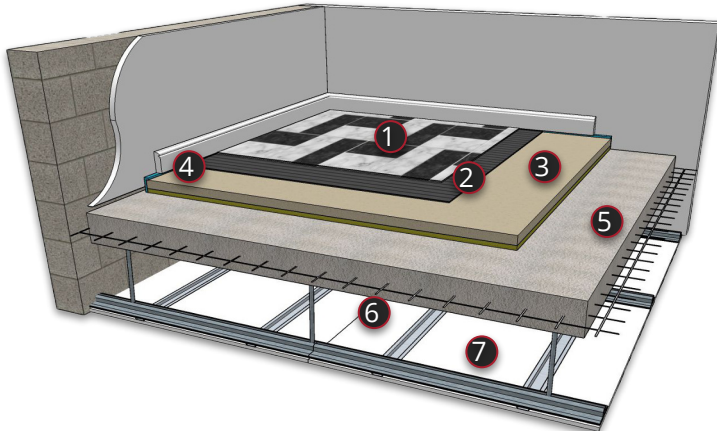

Concrete Insitu Floor

1. Ceramic tiles
2. Electric UFH cables set in tile adhesive
3. Dry ScreedPanel 28 WF
4. L Shaped Flanking strip
5. 200mm Reinforced insitu concrete slab
6. MF ceiling (min 100mm void)
7. 1 x 9.5mm acoustic plasterboard

| |
|--------------|
| DnT,w + Ctr |
| 51dB |
| LnT,W |
| 50dB |
| ΔL_w |
| 19dB |

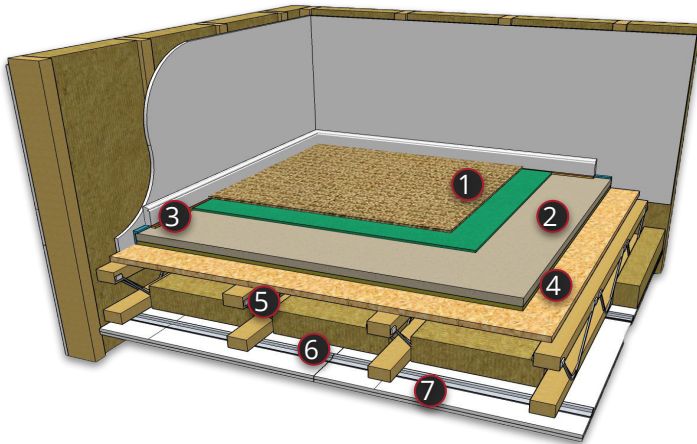

Timber Joisted Floor

1. Carpet & underlay
2. Dry ScreedPanel 28 WF
3. L Shaped Flanking Strip
4. 18mm (min) OSB or Chipboard subfloor
5. 225mm (min) timber floor joist
6. 16mm resilient bars
7. 2 x 15mm acoustic plasterboard

| |
|-------------|
| DnT,w + Ctr |
| 50dB |
| LnT,W |
| 59dB |

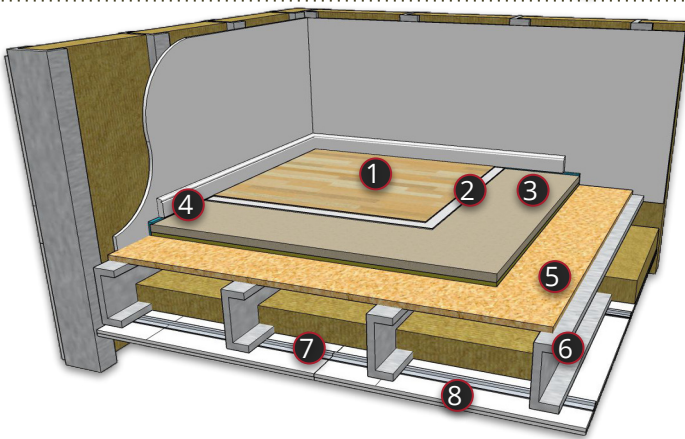

Steel Joisted Floor

1. LVT or sheet vinyl flooring
2. Self-levelling & adhesive layers
3. Dry ScreedPanel 28 WF
4. L Shaped Flanking Strip
5. 18mm (min) OSB chipboard subfloor
6. 225mm (min) steel floor joists
7. 16mm resilient bars
8. 2 x 15mm acoustic plasterboard

| |
|-------------|
| DnT,w + Ctr |
| 53dB |
| LnT,W |
| 58dB |

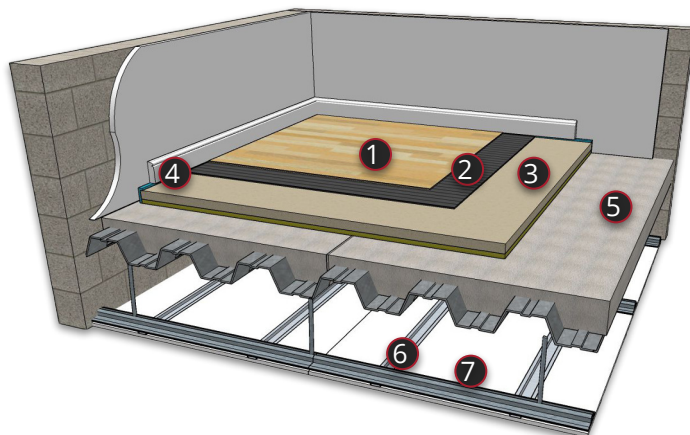

Profiled Metal Deck

1. Engineer timber flooring
2. Adhesive or decoupling layer
3. Dry ScreedPanel 28 WF
4. L Shaped Flanking Strip
5. 130mm concrete on profiled metal deck
6. MF ceiling (min 100mm void)
7. 1 x 9.5mm acoustic plasterboard

| |
|-------------|
| DnT,w + Ctr |
| 52dB |
| LnT,W |
| 50dB |